



Easy With Your
Global Exhibitions

SEG Truss



Product Advantages

As the new type environmental-friendly system
SEG Foldable Truss

1. Aluminum alloy with reinforced nylon surface
2. Matte texture, strong abrasive resistance
3. Convenient to install and save time
4. Saving transport volume and labor cost
5. Flexible size choice from 30cm to 210cm (every 30cm unit increasing)

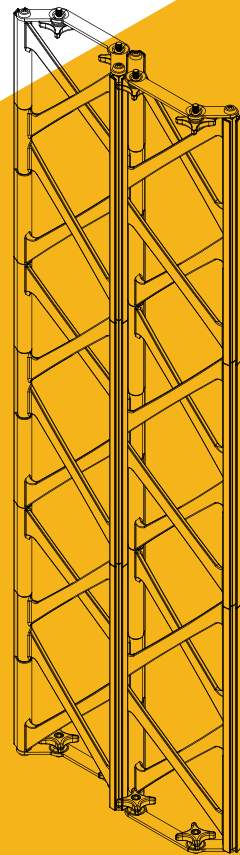

Basic functional accessories

The use of multi-functional accessories makes the shape of the booth flexible, convenient and quick to install, and can meet various construction needs. Make the booth design more flexible.

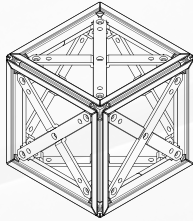

Corner block

+

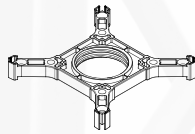

Connector cross

+

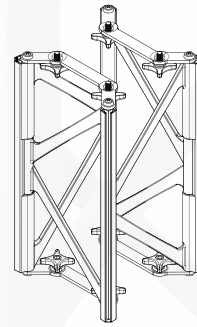

Straight module

Modular & Lightweight

Our display features a lightweight aluminum surface with a nylon finish, perfect for exposure environments. It can be folded for easy transportation, reducing weight and size compared to traditional truss systems. With multi-dimensional connectors, including straight and curved sections, you can create unique and personalized configurations.

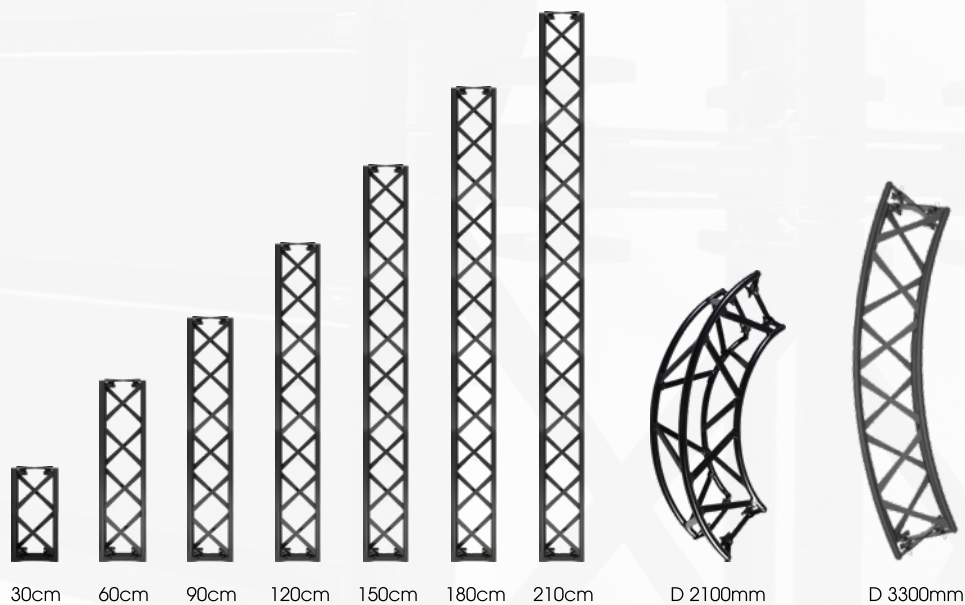

Basic Function Parts

Revamp your booth with the original installation mode of SEG - now with added neon lights for a dazzling and cool effect. This sleek design will make your booth shine and stand out from the rest.



Insert



Spotlight



Track light



Corner block



Connector cross



Regular base



Rectangle base



Corner stiffener

Model	Corner block	Connector cross	Regular base	Corner stiffener	Rectangle base
Frame size(cm)	15x15x15	15x15x2	20.9x20.9	25x25	65x21
Material	Nylon+Iron	Nylon	ABS	IRO	ABS
Net weight(kg)	1.113	0.118	0.293	2.3	0.799

Functional Accessories

Different functional accessories such as lights, adjustable brochure holder, shelving and monitor mounts provided.



Combine with LED lightbox



Combine with LED screen



Neon light strip



Combine with TV



Wooden table



Shelf



Flight case



YC-11-X17

Interconnection **Structure**

Our innovative design connects tube systems, light boxes, and truss walls for surprising effects. Customizable and attention-grabbing, your exhibit will stand out.

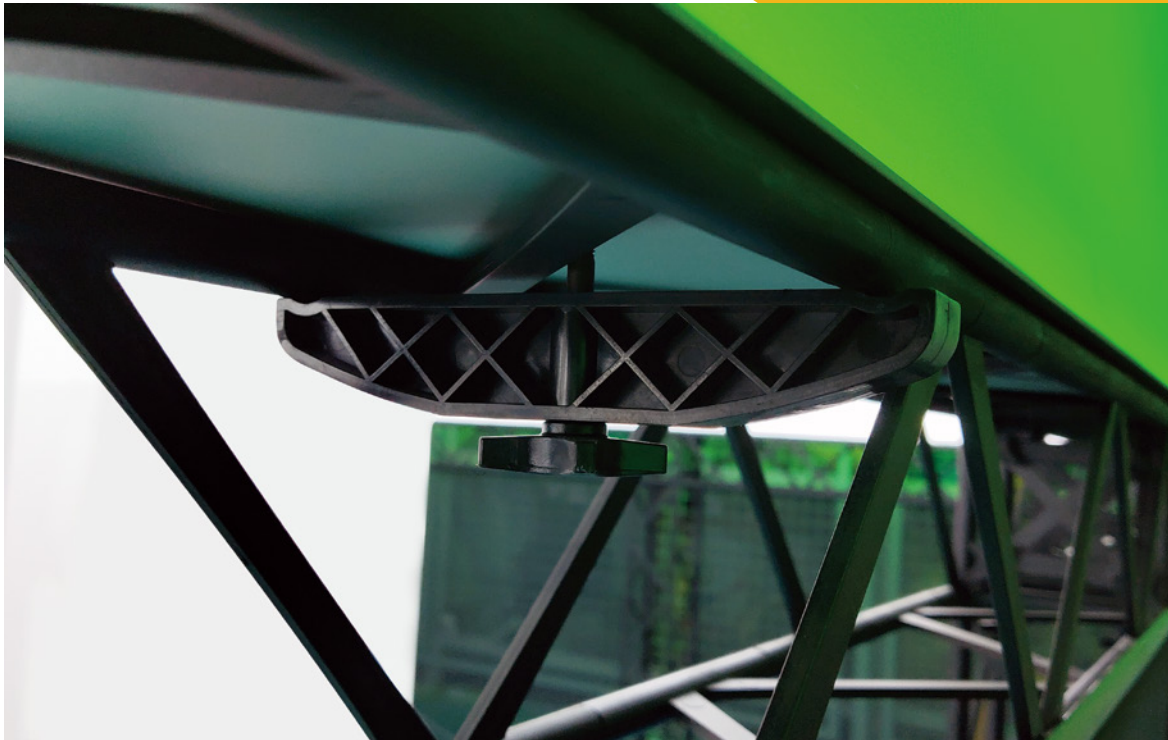

Combine with lightbox

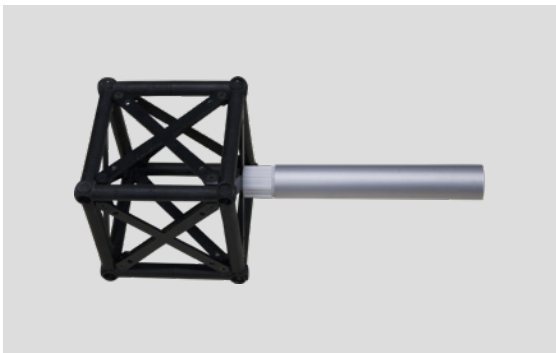

Combine with round tube

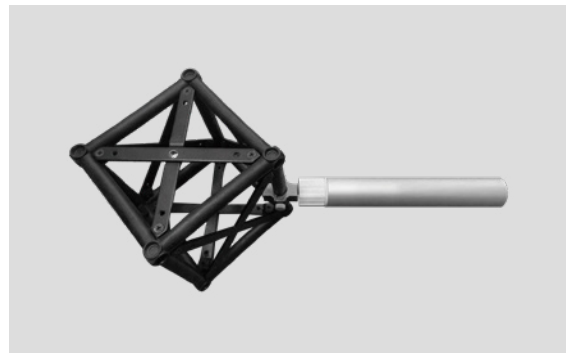

Combine with round tube



Combination Method

There are hundreds of designed application programs or events for your selection. A lot of occasion available, like trade show, advertisement, meeting, wedding, road show and so on.



Booth Solution
18m²

EZ-H18ZX-0003



Area/Height 18m² 3.45m

Take time 2 Hours / 2 Person

Configuration

Carpet/ Desks& Chairs/ Lightbox
Tradeshow Counter/ Long Arm LED Light

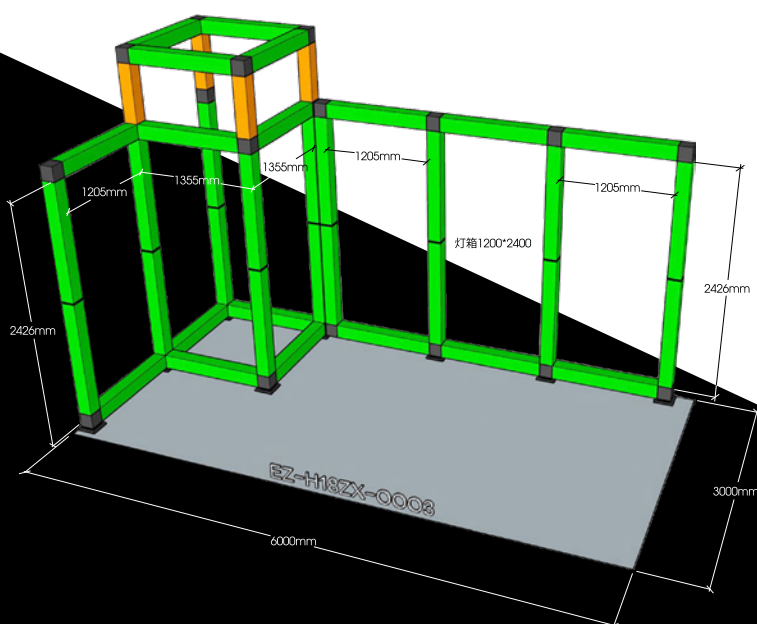

Straight module 600 4 units
Straight module 1200 36 units

Corner block 22 pcs
Connector cross 9 pcs
Clip fitting strip 50 meters
Regular base 8 pcs
Combine with lightbox connector 4 sets
Shelf accessory 1200 4 sets

Booth Solution

36m²

EZ-H36FM-0013



Area/Height 36m² 4.5m

Take time 4 Hours / 2 Person

Configuration

Carpet/ Desks& Chairs/ Lightbox
Trade Show Counter/ Long Arm LED Light

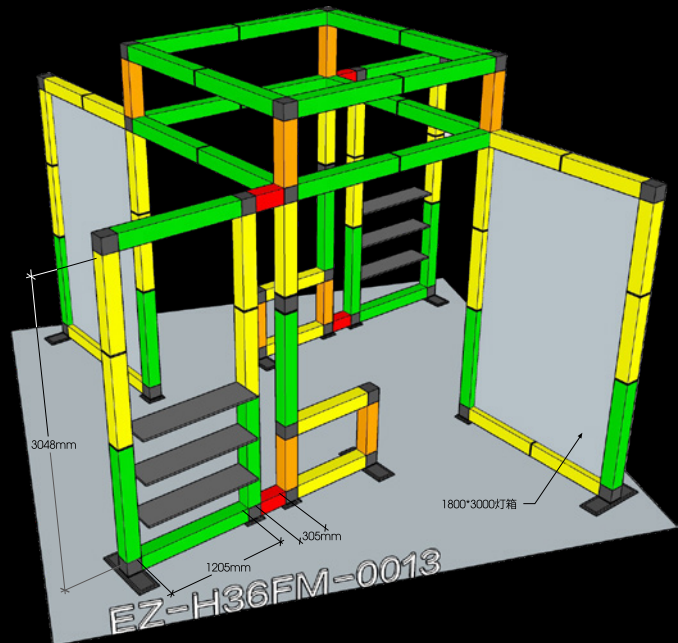

Straight module 300	4 units
Straight module 600	8 units
Straight module 900	30 units
Straight module 1200	30 units

Corner block	32 pcs
Connector cross	28 pcs
Regular base	6 pcs
Long base	6 pcs
Shelf accessory1200	6 sets

EZ-H36GS-0010

Booth Solution

36^{m²}



Area/Height 36m² 4.25m

Take time 4 Hours / 2 Person

Configuration

Carpet/ Desks& Chairs
Lightbox/ Monitor System
Tradeshow Counter/ Long Arm LED Light



Straight module 300	20 units
Straight module 600	18 units
Straight module 900	30 units
Straight module 1200	42 units
Straight module 1500	4 units

Base part accessory	18 pcs
Corner block	48 pcs
Connector cross	22 pcs
Clip fitting strip	86.5 meters

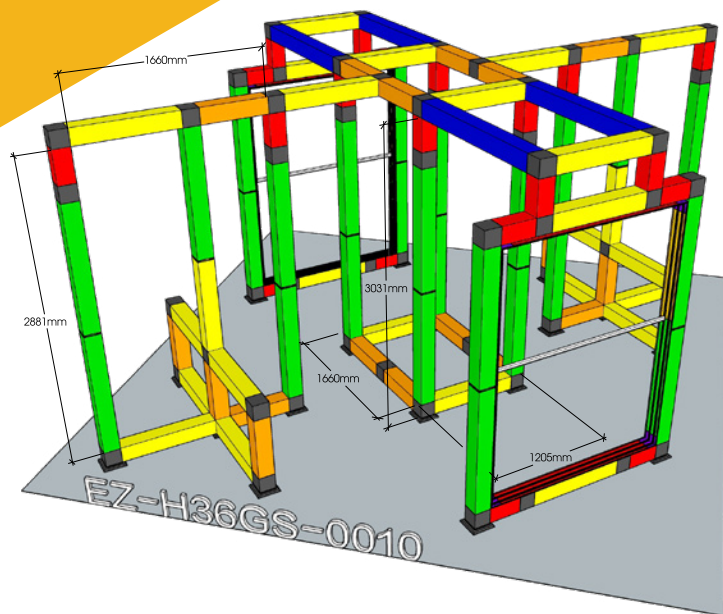



FESPA global print EXPO 2023 24m²



ISA International Sign EXPO 2023 36m²

www.hawkdisplay.com

Add:

(Office) 27 Floor, Wantai Business Palaza, Changzhou, Jiangsu, China

(Factory) No.17 Shuanglong Road, Jintan Economy Development Zone, Changzhou, Jiangsu, China

Tel: +86-519-83903811 Fax: +86-519-83903866

E-mail: info@hawkdisplay.com marketing@hawkdisplay.com